

5 4 3 2 1

D

D

C

C

B

B

A

A

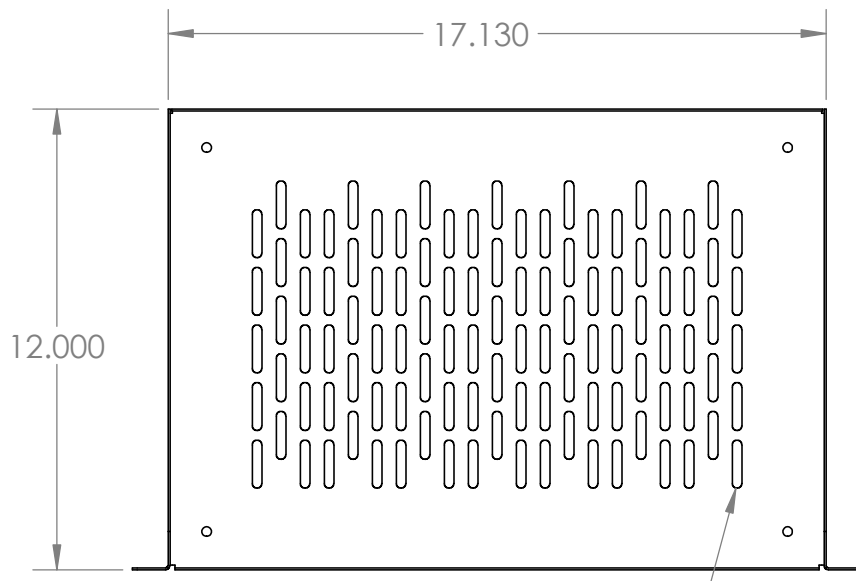

12.000

17.130

105X  $\phi$ .250 X 1.500  
OBROUND

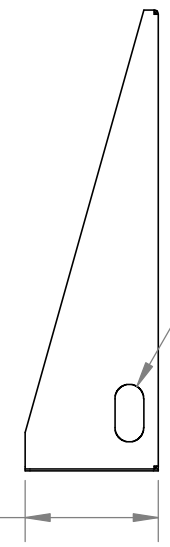

3.470

2X  $\phi$ .750 X 1.500  
OBROUND

2X 3.000

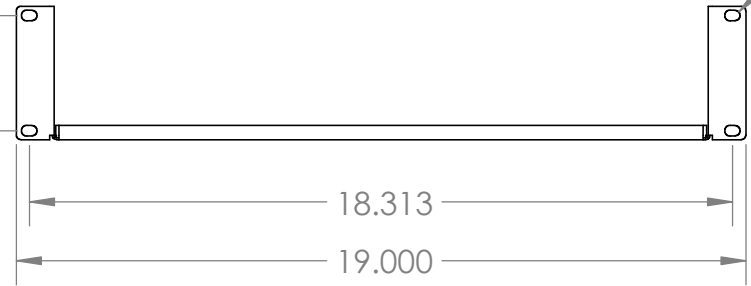

18.313

19.000

4X  $\phi$ .280 X .406  
OBROUND

NOTE: MEDIUM TEXTURE POWDER COAT, BLACK

**KENDALL HOWARD CONFIDENTIAL**  
THE INFORMATION CONTAINED IN THIS DRAWING IS THE SOLE PROPERTY OF KENDALL HOWARD. ANY REPRODUCTION IN PART OR AS A WHOLE WITHOUT THE WRITTEN PERMISSION OF KENDALL HOWARD IS STRICTLY PROHIBITED.

UNLESS OTHERWISE SPECIFIED,  
ALL DIMENSIONS ARE IN INCHES.

TOLERANCES:  
FRACTIONAL:  $\pm 1/8$   
ANGULAR:  $\pm 1^\circ$   
TWO PLACE DECIMAL:  $\pm .03$   
THREE PLACE DECIMAL:  $\pm .010$   
HOLE:  $\pm .005$

| APPROVAL | DATE |
|----------|------|
| DRAWN    |      |
| DESIGN   |      |
| ENG APPR |      |
| MFG APPR |      |

**KENDALL HOWARD**

TITLE:  
**Rack Shelf, Vented, Fixed,  
12.00", 2U**

MANUFACTURING COMMENTS:

MATERIAL:

SURFACE AREA (in<sup>2</sup>):

FINISH ID:

FINISH DESCRIPTION:

LEGACY Part Number:

CLASSIFICATION:

SIZE DWG. NO. REV

**A** LDRS2U12V WP **A**

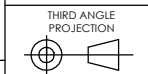

THIRD ANGLE PROJECTION  
INTERPRET DIMENSIONS AND TOLERANCES PER ASME Y14.5-2009

DO NOT SCALE DRAWING

SCALE: 1:5 WEIGHT (lbs): 3.17 SHEET 1 OF 1

ECO No: Description: By: Date: App By:

5 4 3 2 1